

GENERAL OPERATING INSTRUCTIONS

The heart of the gun is the recoil and gripping plates. The slightest pressure on the trigger will cock the gripping plate and drive the piston rod forward. The recoil plate is normally cocked to keep the piston from coming back when pressure is released from the trigger. To pull the rod back, both the gripping plate and the recoil plate must be in neutral (the trigger must be released and the recoil plate must be pressed down or hooked under the recoil lock). If the recoil plate jams and becomes hard to release, try taking some of the load off by squeezing the trigger.

No-Drip Feature

All Albion Deluxe, Special Deluxe and SDL plus guns have a "NO DRIP FEATURE". Simply hook the Recoil Plate under the Recoil Lock and the piston rod will be free to slide back as soon as pressure is released from the trigger.

The adjustment screw on the back of the gun reduces lost motion in the trigger mechanism caused by wear. It is set at the factory and requires adjustment only after long use.

The piston drive rod in the Deluxe, Special Deluxe and SDL plus guns will wear with use. This results in a gradual loss of stroke. When this occurs, remove the rod and turn it 90 degrees to a new wear surface.

Loading Bulk Guns

To load, first remove front cap. Coat the end of gun barrel with solvent to prevent accumulation of material in the threads. Next, immerse the opening, into the material to a depth of about one inch. Move it about slightly so that the material will adhere to the barrel and form an air seal. While holding the barrel, pull piston rod back slowly, about 1" at a time. Pause between pulls to permit material to follow the piston. In this way, the barrel will fill with a minimum of air pockets. Remove gun and use a putty knife to cut off any strings of extra material. Clean off excess from barrel and replace front cap.

Loading Sleeves, Follow Plates and Gun Loaders are also available from Albion to facilitate this operation. Oil or other light viscosity liquids can be drawn up into the gun directly through the nozzle.

Loading Sausage Packs

First remove front cap. Next, depress the recoil plate and pull the piston to back of gun. Insert sausage into barrel, then cut off the end with a knife or scissors. Replace front cap and release the recoil. If the material seems difficult to dispense, check to be sure the sausage has been adequately opened and that a metal clip or end flap is not stuck in the nozzle inlet.

Note that the gun will completely dispense its load before the piston rod has finished its stroke. Stop pumping at this point, remove front cap and use the balance of the stroke to eject the empty sausage skin. Excessive pressure against the compacted skin will damage gun piston.

CONTINUED ON BACK PANEL



Nomenclature

FULL-BARREL 2" DIAMETER MODELS

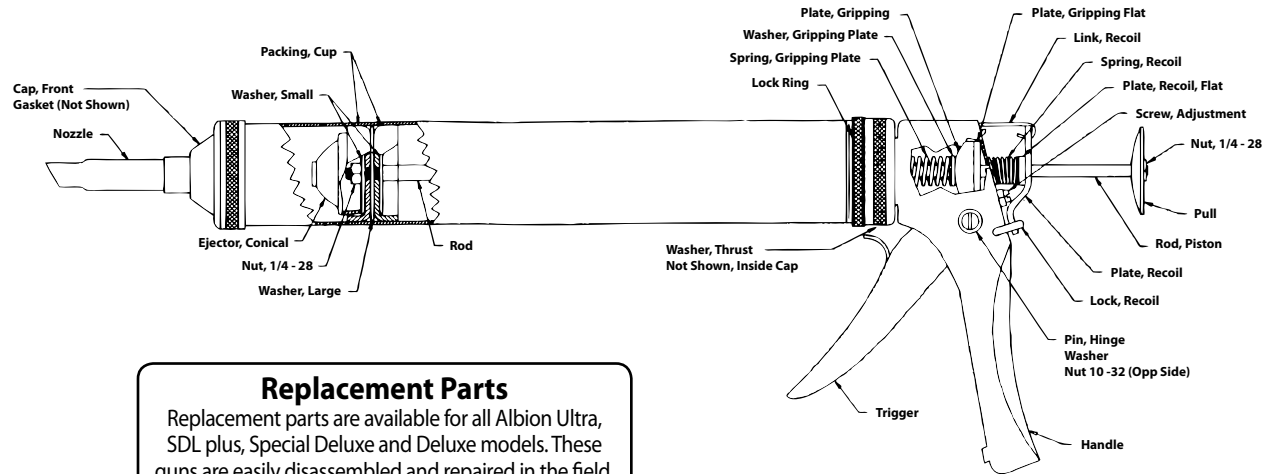

Replacement Parts

Replacement parts are available for all Albion Ultra, SDL plus, Special Deluxe and Deluxe models. These guns are easily disassembled and repaired in the field.
Ask Us! 1-800-359-6614

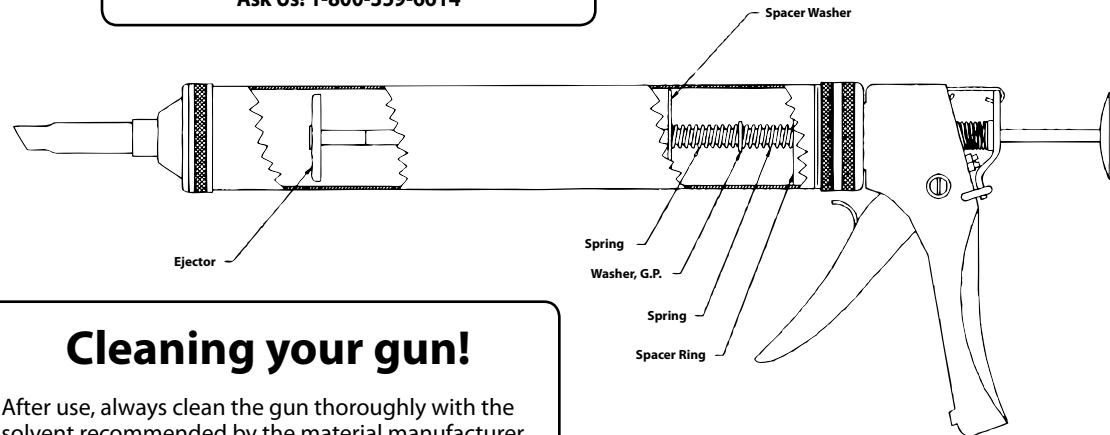

Cleaning your gun!

After use, always clean the gun thoroughly with the solvent recommended by the material manufacturer. Carefully remove any residue of caulk or sealant from the piston drive rod with steel wool. Lightly oil the piston rod and the drive mechanism. Many solvents will "leach" the oil out of the leather piston packings used in the bulk guns, causing them to stiffen and shrink. Soaking them in light oil will significantly extend their life. While leather is the most universally desirable material for piston packings, Albion offers a broad selection of packing materials and expanders to improve performance in particular situations.

"Polyfinger" Sausage Piston

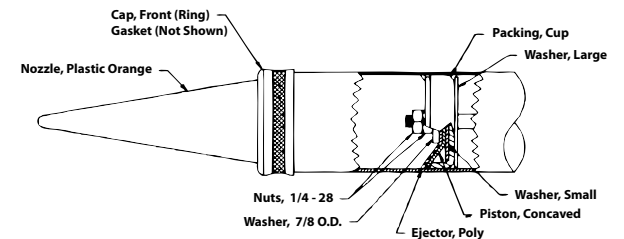

Large Diameter Full-Barrel Models

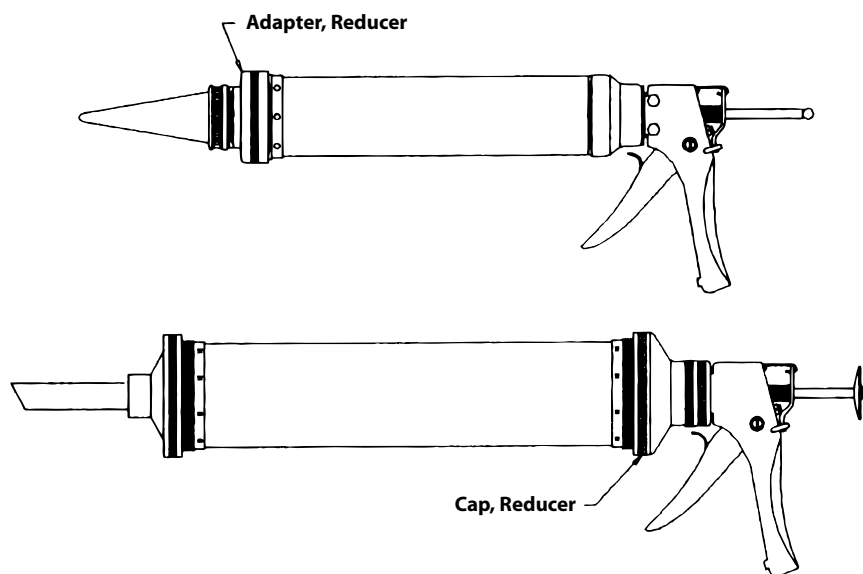

Cartridge Models

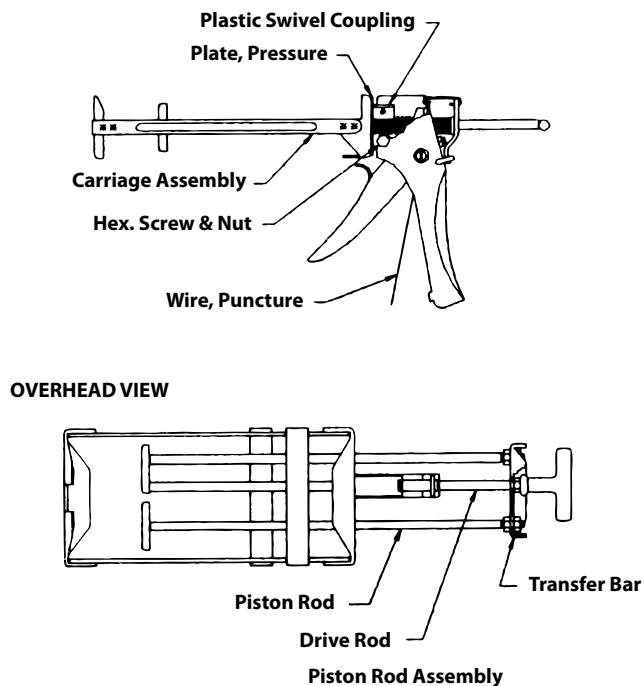

Sausage Piston Assemblies

It is very important that the inside of the barrel is absolutely clean when pumping sausage packed material. Otherwise, the skin will tend to stick to the gun barrel and blow by the piston. Guns using Albion's Teflon piston are assembled with the Teflon piston facing out in a fashion similar to a bulk gun. When assembling the polyethylene finger-type piston, note that the leather cup next to the handle also faces out. See nomenclature drawing.

Converting Combination Guns from Cartridge to Bulk Use

First, remove front cap and push piston rod forward. Unscrew metal piston ejector. Slip all cartridge spacer springs off piston rod (only on some models). Pull piston rod back so that tip is about 1" inside barrel. From the piston kit, drop a metal backing washer on the rod. Next add one of the cup packings with the cup facing in. To do this, first insert the packing into the barrel on an angle. Then straighten it into position and insert the tip of the piston rod. Insert a second cup facing the opposite direction, followed by another metal washer and then a nut. Some conversion kits come with one larger diameter metal washer. This is assembled between the two cup packings.

Converting Bulk Guns to Cartridge Use

Most Albion Bulk Guns can be converted to dispense cartridges. The two basic ingredients required are a metal ejector and a system of spacers to insure proper seal between the front cap and the cartridge. The spacers are not needed if cartridge spout can be cut so it will wedge into gun nozzle. The actual assembly steps are the reverse of those previously described for converting to bulk use. Remove piston nut, pull back piston rod, tip over pistons, and remove them from barrel. Install the required spacers and screw on the metal piston ejector.

Adjusting Twin-Component Guns for Cartridge Fit

Before changing the factory set-up on your gun, make sure it is possible to adjust it for the cartridge set you plan to use. Check to insure that the ejectors are small enough to seat in the cartridge piston. Make sure the cartridges fit with their full face flush against the front cap. In some situations, it is necessary to slide the narrow neck of the spout into the slot in the front cap in order to properly seat the cartridge.

Loosen locking nuts before adjusting or replacing ejectors. Use the largest diameter ejectors that will fit your cartridge. Center them with the cartridge, being sure to keep both faces even and in the same plane. Tighten locking nuts to maintain alignment. This is particularly important with ejectors that have off-center threads.

On models where all three rods of the piston rod assembly are on a common centerline, the piston rods can be moved to different hole locations to properly position the ejectors. In this case, note that the largest ejector used should cover and touch the end of the drive rod as well as the piston rod onto which it is assembled (see Cartridge Model overhead view). Often, no adjustment to this ejector or piston rod is necessary.

Some models are supplied with brackets to help center the back end of smaller diameter cartridges. To use a larger cartridge, simply remove the screws holding them in place. Bracket Kits are available if needed.

Schroeder Log Home Supply, Inc.
www.loghelp.com 1-800-359-6614